

### TRANSFORMER BOX PLUG ASSEMBLIES

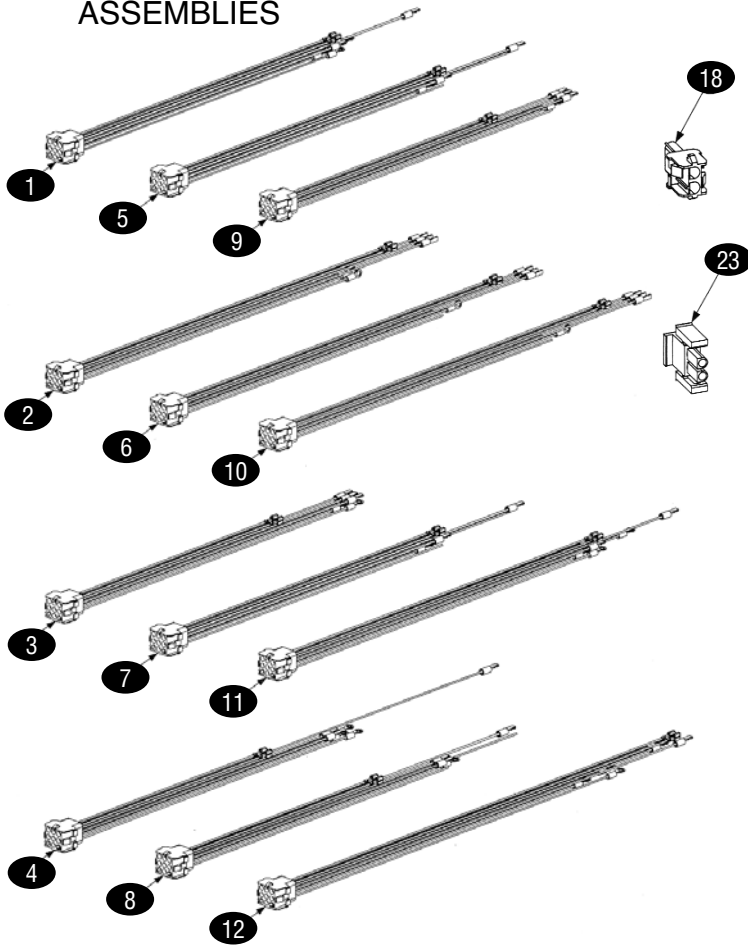

### PIN TERMINALS

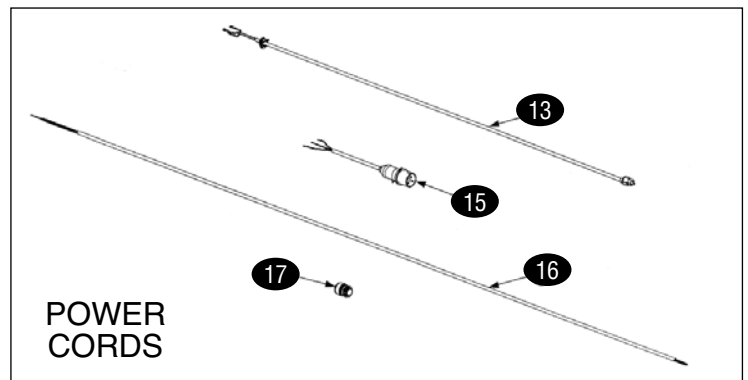
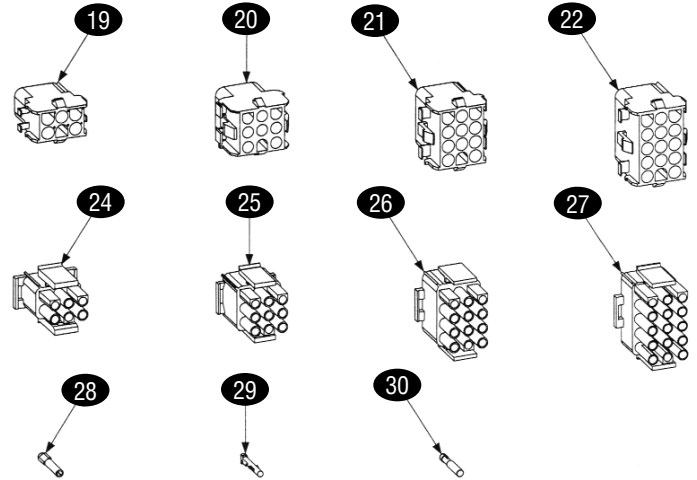

### POWER CORDS

KEY	PART #	DESCRIPTION	KEY	PART #	DESCRIPTION
1	FM806-6164SP	FMH150,MJ/FM/FP250-Right,MJ/FM/FPH350/450-Left Front	19	FM807-0158	6-Pin Female
2	FM806-6165SP	MJ/FM/FPH250-Left, MJ/FM/FPH350/450-Left Rear	20	FM807-0156	9-Pin Female
3	FM806-6166SP	MJ/FM/FPH350-Right, MJ/FM/FPH450-Right Rear	21	FM807-0159	12-Pin Female
4	FM806-6167SP	MJ/FM/FPH450-Right Front	22	FM807-0875	15-Pin Female
5	FM806-6637SP	FMH150 CE, MJ/FM/FPH250 CE-Left	23	FM807-1067	2-Pin Male
6	FM806-6638SP	MJ/FM/FPH350 CE-Left Front, MJ/FM/FPH450 CE-Left Rear	24	FM807-0157	6-Pin Male
7	FM806-6639SP	MJ/FM/FPH350 CE-Left Rear, MJ/FM/FPH450 CE-Left Front	25	FM807-0155	9-Pin Male
8	FM806-6640SP	MJ/FM/FPH350 CE-Right Front	26	FM807-0160	12-Pin Male
9	FM806-6641SP	MJ/FM/FPH350 CE-Right, MJ/FM/FPH450 CE-Right Rear	27	FM807-0804	15-Pin Male
10	FM806-6642SP	MJ/FM/FPH250 CE-Right	28	FM826-1341	Terminal, Female Split Pin
11	FM806-8712SP	MJ/FM/FPH250-Left	29	FM826-1342	Terminal, Male Split Pin
12	FM806-8713SP	MJ/FM/FPH250-Right	30	FM807-2518	Plug, Mate-N-Lock, Dummy Pin
13	FM806-5332SP	Power Cord, 120V w/Grounding Plug, Push-On Terminals & Clamp			
n/s	FM806-7742SP	Power Cord, 120V w/Grounding Plug, w/Ring Terminals, no Clamp			
n/s	FM807-0154	Power Cord, 120V w/Grounding Plug, w/o Terminals or Clamp			
15	FM807-1696	Power Cord, CE			
16	FM807-1685	Power Cable, 110", 3-wire, 16-gauge, 450V, 18A			
17	FM807-1560	Strain Relief			
18	FM807-1068	2-Pin Female			