

# warming

STEAMERS

DFWT-200

**HAGAR**

**roundup**  
FOOD EQUIPMENT DIVISION

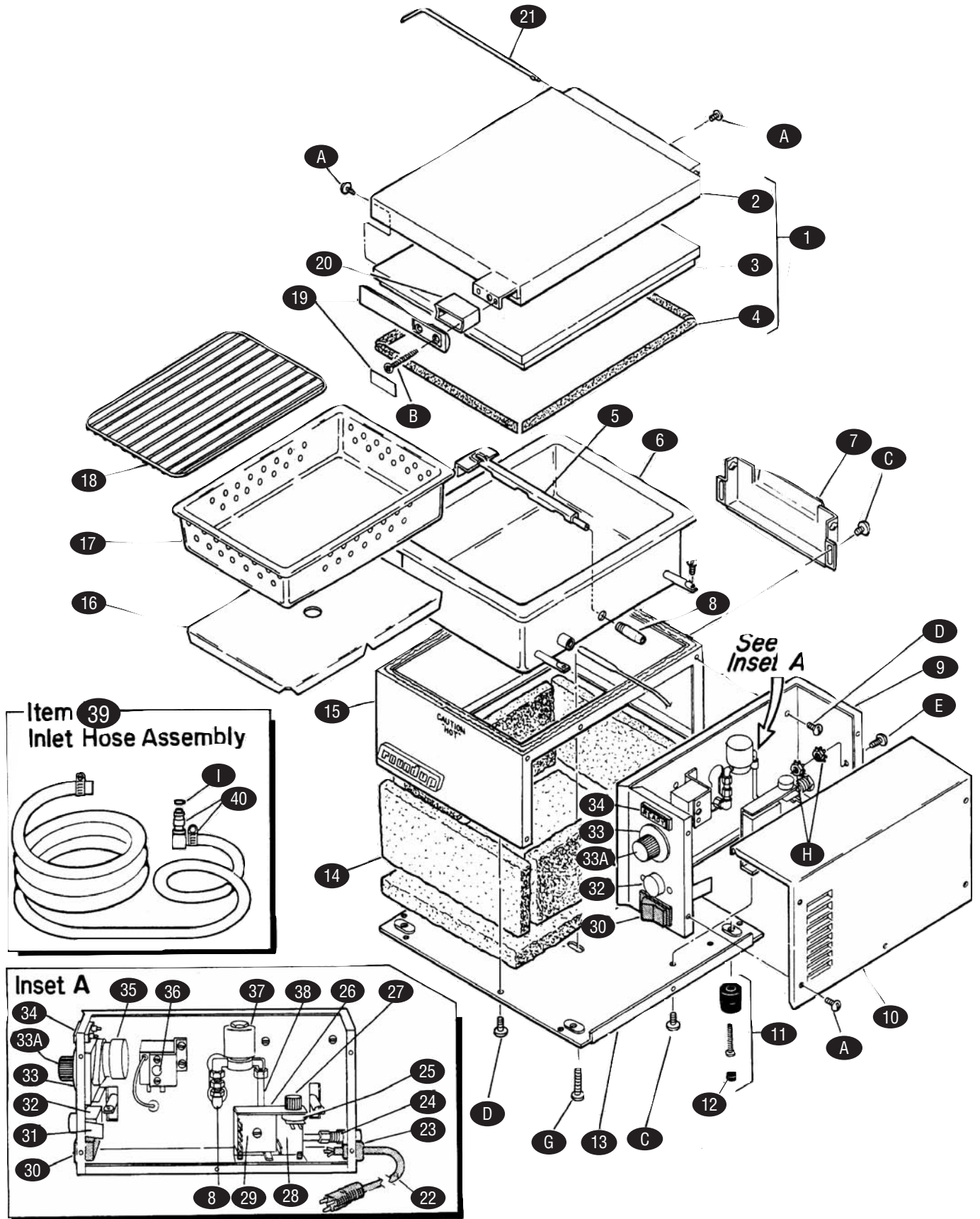



| KEY | PART #    | DESCRIPTION   | KEY | PART #    | DESCRIPTION                                    |
|-----|-----------|---|-----|-----------|--|
| 1   | RU0011154 | Top Cover Assembly  | 36  | RU403K157 | Thermostat Kit                                 |
| 2   | RU0020577 | Top Cover Shell   | 37  | RU0020699 | Solenoid Kit, 120 VAC (incl. 90° Elbows)       |
| 3   | NLA       | Top Cover Liner (incl. #1)  | 38  | RU200K133 | Inlet Tube Kit                                 |
| 4   | RU020K105 | Gasket, Top Cover   | 39  | RU0010584 | Inlet Hose Assembly                            |
| 5   | RU0010146 | Spray Tube Assembly   | 40  | RU7000139 | Quick Disconnect Kit                           |
| 6   | RU7000126 | Steam Generator, 120 VAC  |     |           | Note: Following items available in pkgs. of 10 |
| 7   | RU0501569 | Top Cover Hinge   | A   | RU308P103 | Screw, #8-32x1/4", Stainless Steel             |
| 8   | RU200K132 | Steam Generator Tube (incl. Tube, 90° Elbow & connector Fittings) | B   | RU308P132 | Screw, #8-32x3/4" Flat, Stainless Steel        |
| 9   | NLA       | Electrical Housing (Timer models)                                 | C   | RU308P104 | Screw, #8-32x3/8", Stainless Steel             |
|     | NLA       | Electrical Housing (Non-Timer models)                             | D   | RU308P116 | Screw, #8-32x1/4", Zinc                        |
| 10  | RU0501541 | Access Cover Assembly   | E   | RU308P105 | Screw, #8-32x1/2", Stainless Steel             |
| 11  | RU7000130 | Leg Kit   | G   | RU325P106 | Screw, 1/4"-20x2", Zinc                        |
| 12  | RU2180145 | Cover   | H   | RU306P143 | Hex Nut, #8-32 "KEPS"                          |
| 13  | NLA       | Base Plate  | I   | RU020P117 | O-Ring   |
| 14  | RU7000132 | Insulation Kit  |     |           |  |
| 15  | NLA       | Main Housing  |     |           |  |
| 16  | RU0500323 | Diffuser Pan  |     |           |  |
| 17  | RU2130103 | Perforated Pan  |     |           |  |
| 18  | RU0800109 | Trivet  |     |           |  |
| 19  | RU7000133 | Handle Kit  |     |           |  |
| 20  | RU0020964 | Handle Bracket Cover  |     |           |  |
| 21  | RU0800219 | Top Cover Hinge Pan   |     |           |  |
| 22  | RU0700300 | Power Cord, 120 VAC   |     |           |  |
|     | RU0700375 | Power Cord, 240 VAC   |     |           |  |
| 23  | RU040P121 | Strain Relief, pkg. of 10   |     |           |  |
| 24  | RU208K106 | Quick Disconnect Body   |     |           |  |
| 25  | RU0020194 | Time Shot Control, TS Model (incl. items #26 & 27)                |     |           |  |
|     | RU0020526 | Time Shot Control, all other models (incl. items #26 & 27)        |     |           |  |
| 26  | NLA       | Label (k0.5 seconds)  |     |           |  |
| 27  | RU2100115 | Knob  |     |           |  |
| 28  | NLA       | Time Shot Control Bracket   |     |           |  |
| 29  | NLA       | Solid State Timer, Cube, 220-240 VAC, 50 Hz                       |     |           |  |
| 30  | RU4010104 | Power Switch, 120 VAC   |     |           |  |
|     | RU4010105 | Power Switch, 220-240 VAC   |     |           |  |
| 31  | NLA       | Insulator (215/260)   |     |           |  |
| 32  | RU4010106 | Operate Switch  |     |           |  |
| 33  | NLA       | Timer Dial, 15 Min., (incl. item #33A)                            |     |           |  |
|     | NLA       | Timer Dial, 60 Min., (incl. item #33A)                            |     |           |  |
| 33A | NLA       | Timer Dial Center Button  |     |           |  |
| 34  | RU4060102 | "READY" Light, 120 VAC  |     |           |  |
|     | RU4060123 | "READY" Light, 220-240 VAC, 50 Hz                                 |     |           |  |
| 35  | NLA       | Main Timer, 15 Min., 120 VAC                                      |     |           |  |
|     | NLA       | Main Timer, 60 Min., 120 VAC                                      |     |           |  |
|     | RU402K108 | Main Timer, 60 Min., 230 VAC, 50 Hz                               |     |           |  |